

CHILDREN'S BED

WHAT'S IN THE BOX?

- 2x Headboard A
- 2x Bed end B
- 3x Bow part C
- 2x Leg part D

Note: an extra headboard is included.

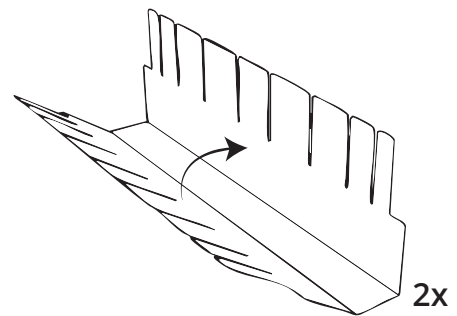
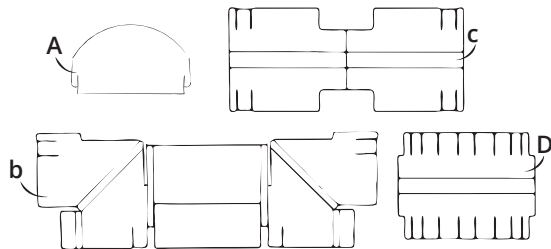
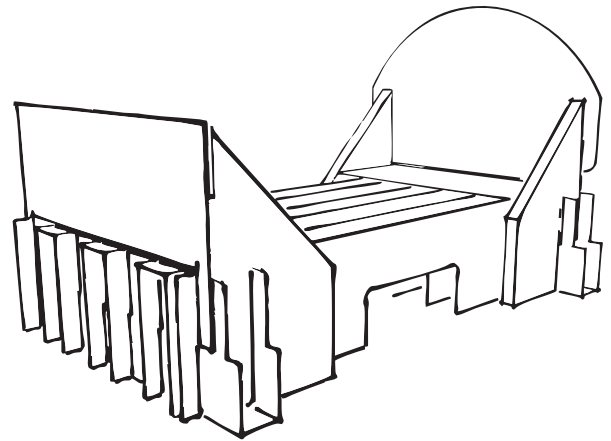

1. Check that you have all the parts.

2. Prepare the legs by folding them up along the fold lines as shown.

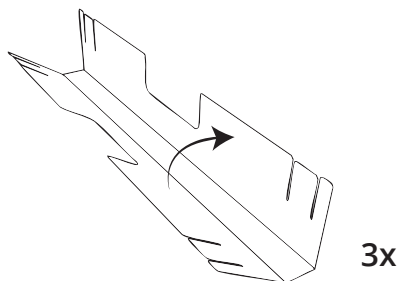

3. Then also do this for the arched parts of the bed.

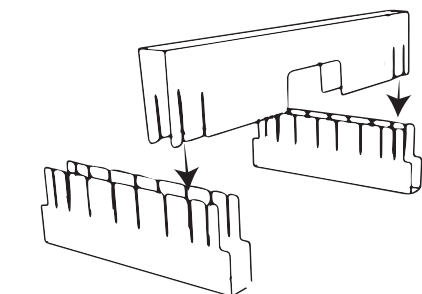

4. Now slide the parts together into the appropriate slots. Leave the outer groove of the leg part empty.

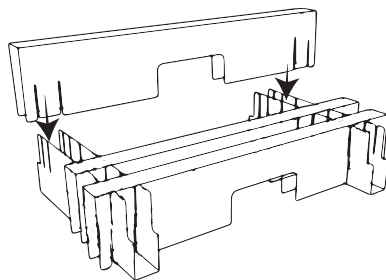

5. Place the remaining arch parts in the appropriate slots.

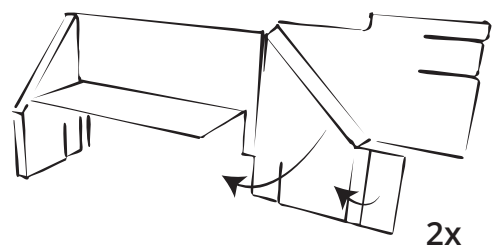

6. Fold bed ends B inwards along all fold lines as shown on the left.

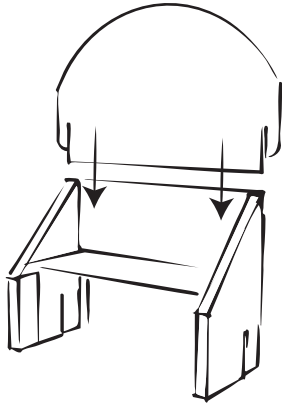

7. Slide headboard A into one of the bed ends.

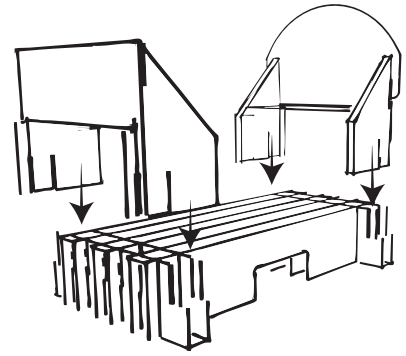

8. The final step is to slide the headboard and footboard into the outer slots and the bed is ready!