

# MEDAL STAGE

## WHAT'S IN THE BOX?

- 2x Number 3 bottom A
- 2x Number 2 bottom B
- 2x Number 1 bottom C
- 1x Number 3 box D
- 1x Number 2 box E
- 1x Number 1 box F

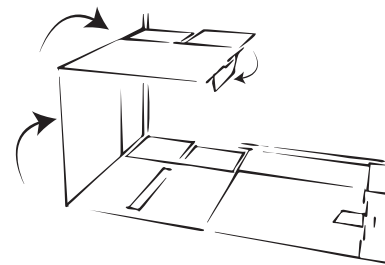
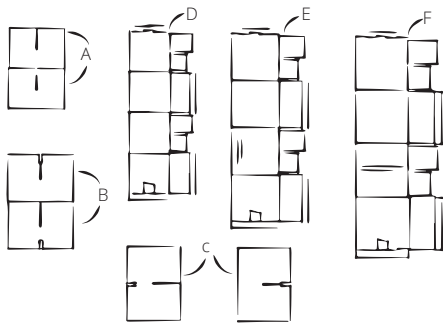
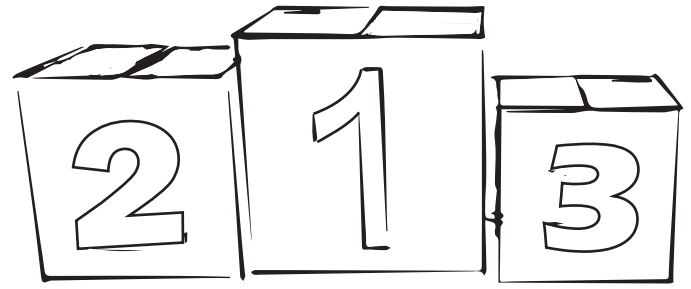

1. Make sure you have all the parts.

2. Grab part D, E or F and fold the first two large surfaces 90 degrees and do this also with the protruding flap.

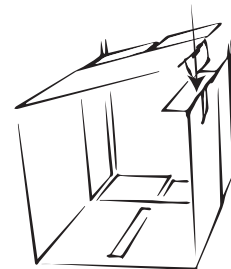
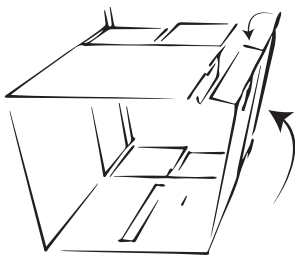

3. Finish the block by folding all sides.

4. Then slide the end of the top side into the slot of the side to which it connects.

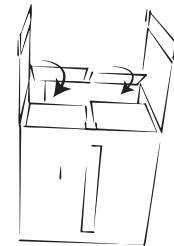
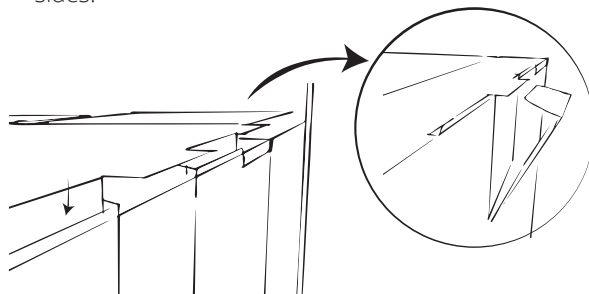

5. Then slide the middle loose part of the lower side into the small slot of the top side.

6. Put the box upright and fold the four loose small flaps inwards.

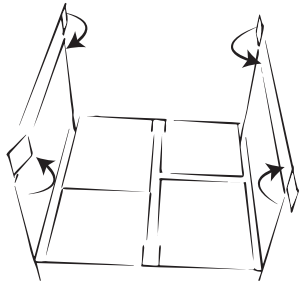

7. Then from the two still standing parts, fold the four protruding parts completely inwards.

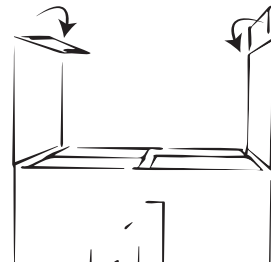

8. Then fold the edge with the newly folded pieces on the folding edge 90 degrees inwards.

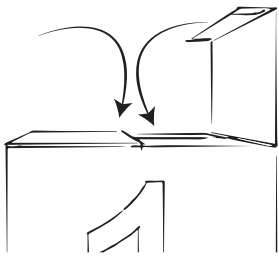

9. Then fold the two large parts inward to close the box.

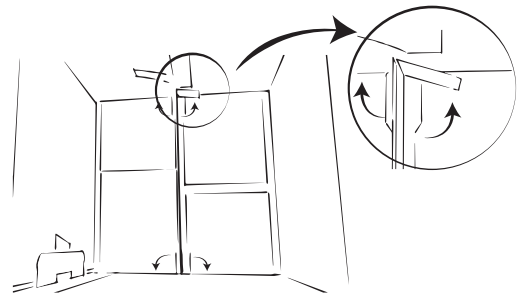

10. Turn the box over and fold the small flaps back to fasten everything.

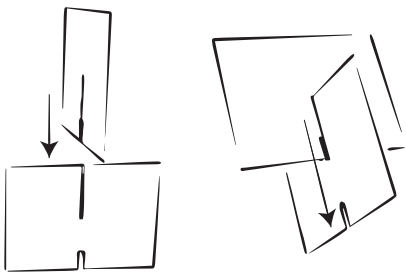

11. Now take from parts A, B or C the part belonging to the number box you have and insert these crossed into each other.

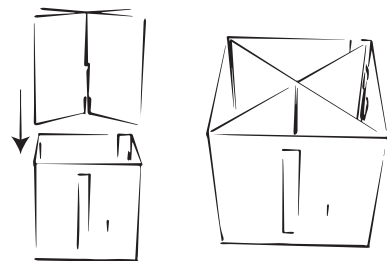

12. Grab the cross and place it in the bottom of the box with the big slit down.

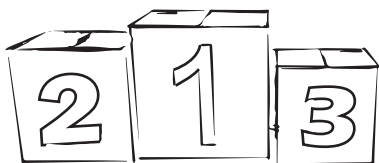

13. Repeat these steps with the other two boxes and place them next to each other.