

Canal House

WHAT'S IN THE BOX?

- 1x Front wall A
- 2x Side wall B
- 1x Back wall C
- 1x Roof D
- 1x Hoist part 1
- 1x Hoist part 2

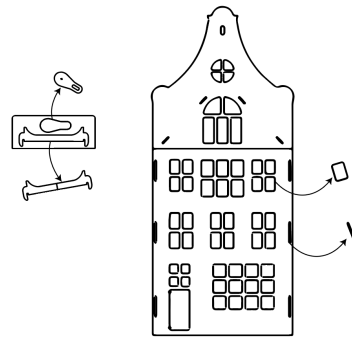
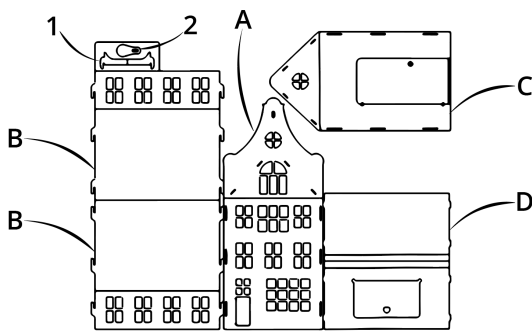
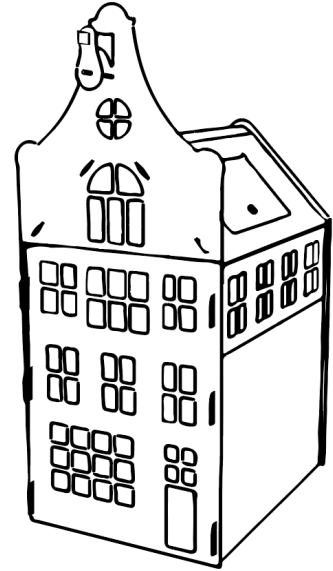

1. Check if you have all the parts.

2. Break out the loose parts.

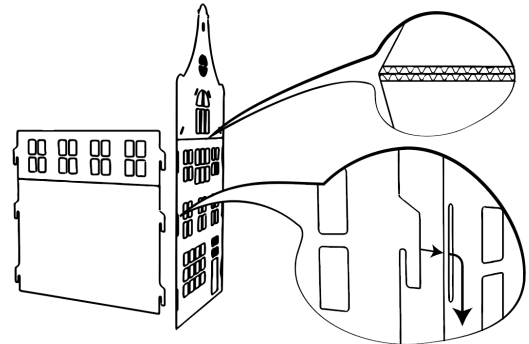
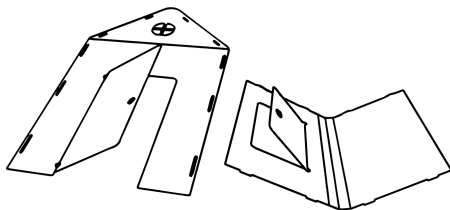

3. Carefully prefold all fold lines once.

4. Make sure the cuts are on the outside of the house and then hook the sidewalls into the cutouts in the front wall.

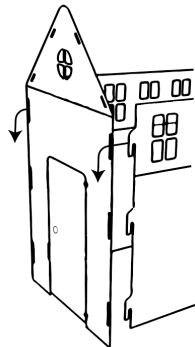

5. Hook the other slots of the side walls into the back wall.

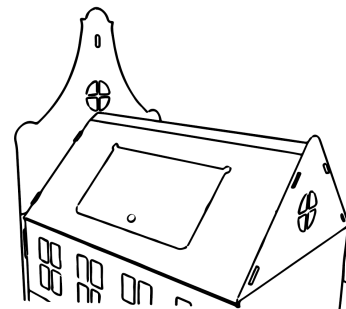

6. Clamp the roof between the front and back walls by clicking the protrusions of the roof into the cutouts.

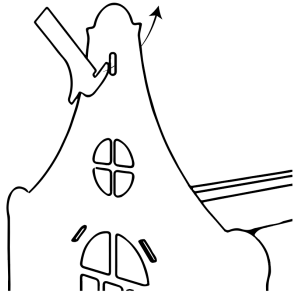

7. Hook hoist part 1 into the slot in the front wall.

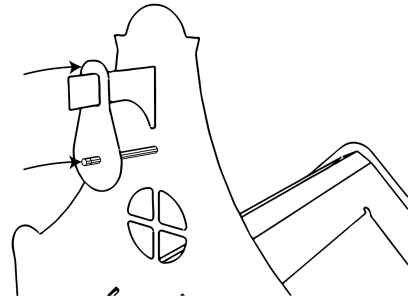

8. Slide hoist part 2 over hoist part 1 and insert a pen or pencil through hoist part 2 and the front wall. Your house is now finished!