

LIGHTLETTER

WHAT'S IN THE BOX?

- 1x Letterbord A
- 1x 10 lamps on cord B

ADD IT YOURSELF

- 3x AA batteries

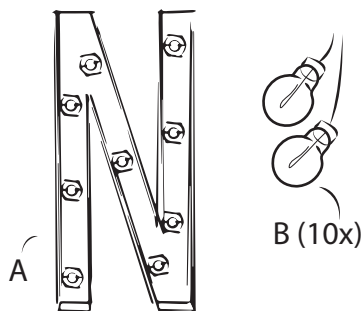
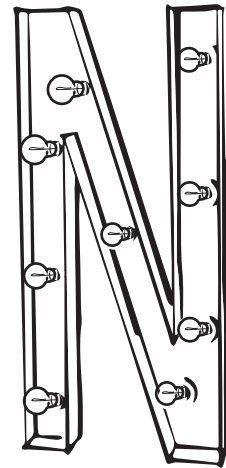

1. Make sure you have all the parts.

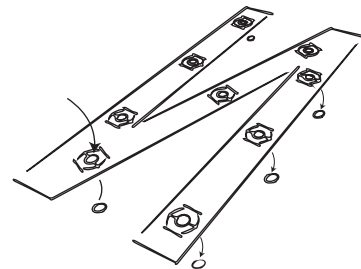

2. Break out any loose parts.

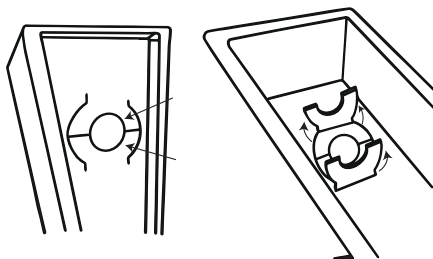

3. Push the flaps through the back, so that they open at the front.

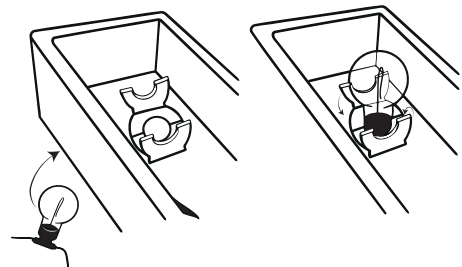

4. Put the lamps through the lightletter from the back and then press the flaps closed again so that the lamp is stuck.

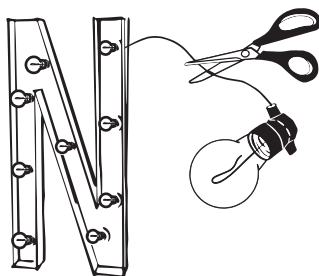

5. Cut the last lamp(s) off the cord, if you have any lamps left.

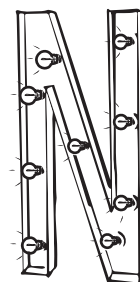

6. Add the batteries, turn on the lights and your light letter is ready to shine.