

Wardrobe

WHAT'S IN THE BOX?

- 1x Vertical wall left A
- 1x Vertical wall middle B
- 1x Vertical wall right C
- 1x Wide shelf D
- 3x Narrow shelf E

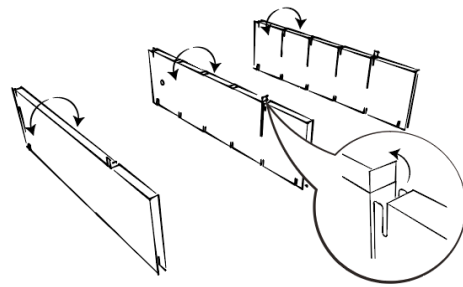
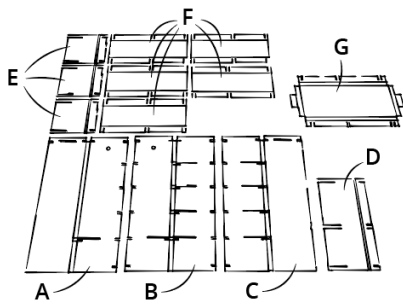
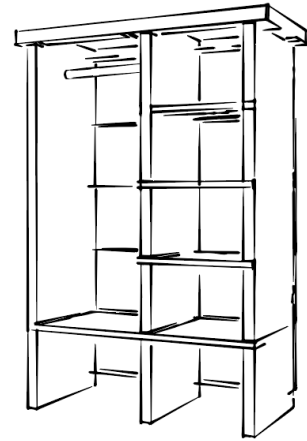

1. Check if you have all the parts.

2. Fold the vertical walls A, B and C over the fold lines. Fold the flaps up at the incisions.

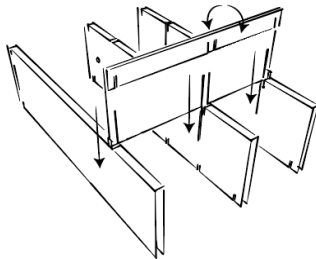

3. Fold the wide plank D over the fold lines and slide it into the incisions at the bottom of the vertical walls.

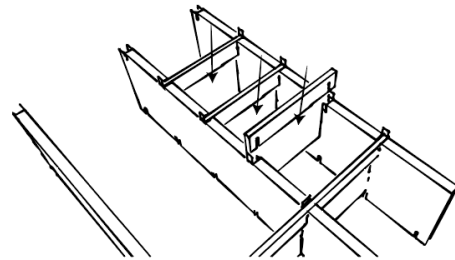

4. Fold the narrow planks E over the fold lines and slide them into the other cuts in the walls.

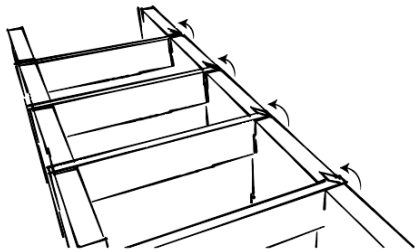

5. Fold all the flaps down so that the incisions are no longer visible.

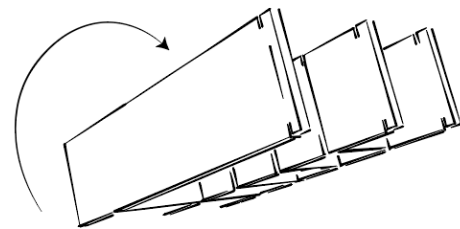

6. Turn the entire cabinet over so that it is on its front.

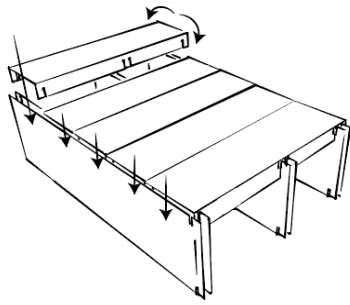

7. Fold the back parts F over the fold lines and slide into the cuts in the back.

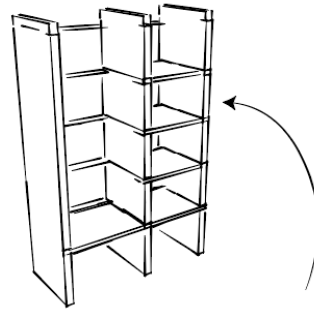

8. Stand the cabinet upright.

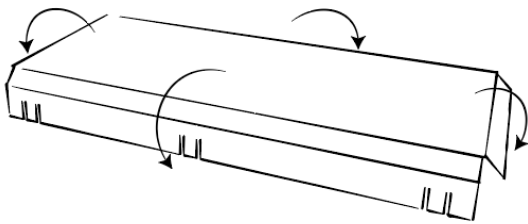

9. Fold the top flaps G over the fold lines.

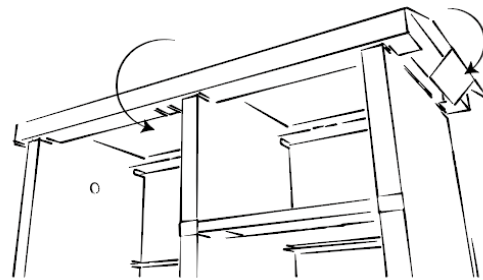

10. Attach top G to the cabinet by folding the flaps over. Do the long sides first and then the short sides.

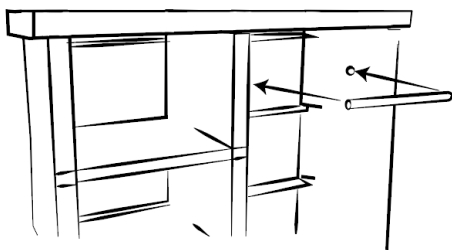

11. Place the wooden stick in the gaps between the right and middle wall and the wardrobe is ready!

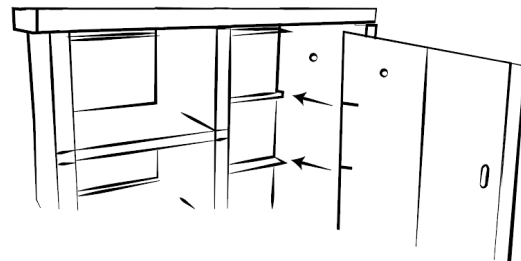

12. Slide the doors between the outer walls as shown. Then follow step 11 and proceed to step 13.

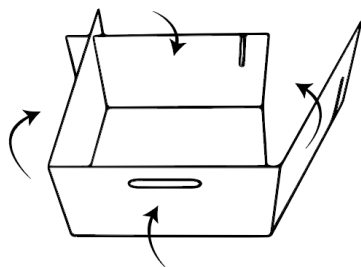

13. Fold the tray in over the fold line and slide the sides into the slots in the back.

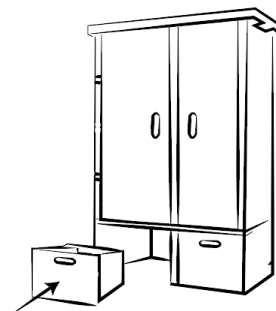

14. Place the drawers under the cabinet and the wardrobe is ready.